

MARIAN ANDERSON THEATER

Stage Plot

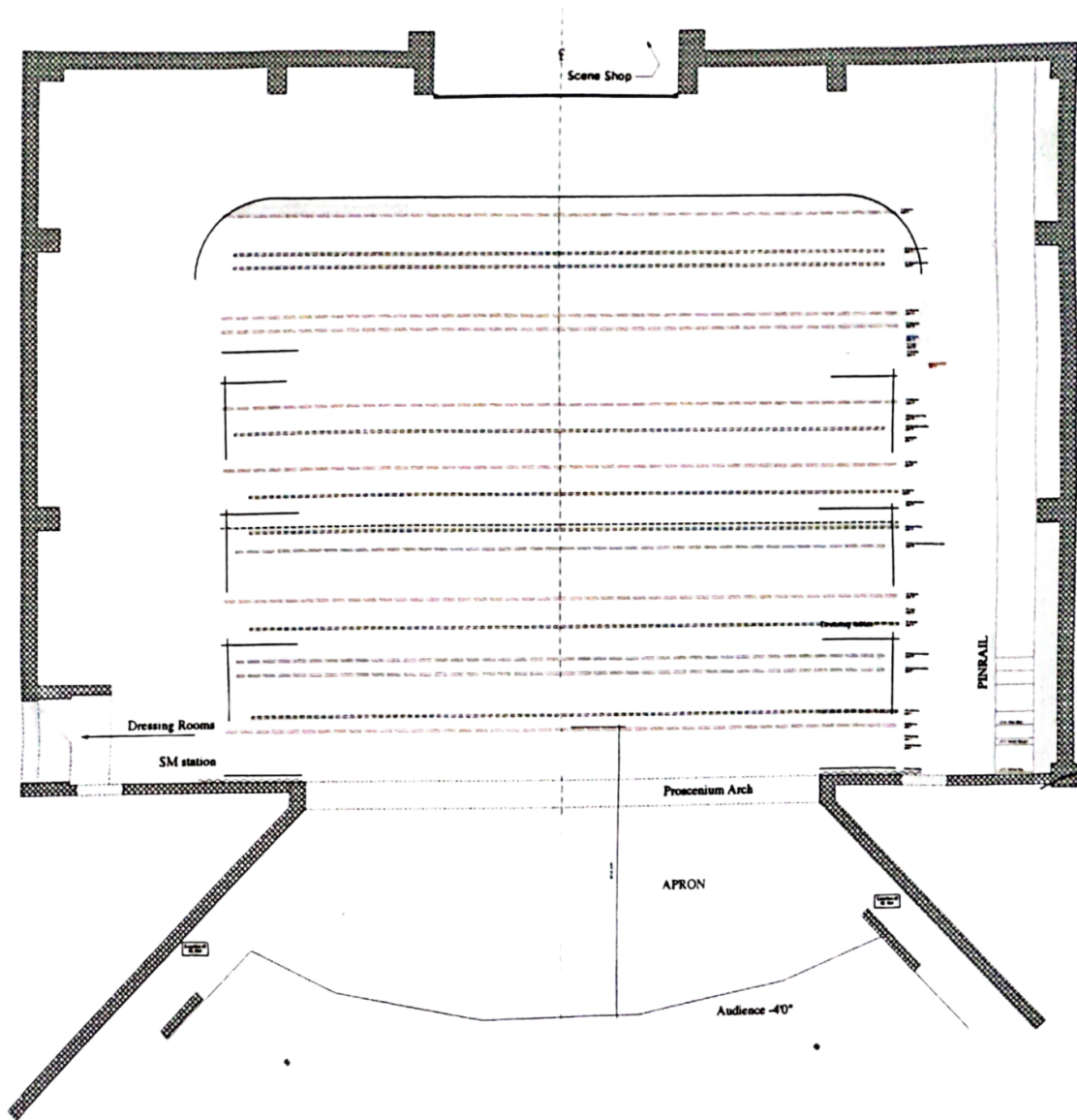

MARIAN ANDERSON THEATER

Stage Specifications

Proscenium Width	40' (12.19 M)
Proscenium Height	24' (7.32 M)
Plaster Line to Back Wall	50' (15.24 M)
Plaster Line to Apron Edge (at center)	
With Orchestra Pit Platforms Down	2' (0.61 M)
With Orchestra Pit Platforms Up	17' (5.18 M)
Center Line to Stage Left Rail	
Downstage	40' (12.19 M)
Upstage	40' (12.19 M)
Stage Height from Audience Floor	4' (1.22 M)
Follow Spot Positions to Plaster Line	90' (27.43 M)
Follow Spot Positions Height from Stage Floor	36' (10.97 M)
Working Orchestra Lift Space	41' x 12' (12.5 x 3.66 M)
Plaster Line to Last Line Set	44' (13.41 M)
Plaster Line to Curtain Line	2' (0.61 M)
Lighting Coves 1 to Plaster Line	32' (9.75 M)
Lighting Coves 1 Lights from Stage Floor	50' (15.24 M)
Lighting Cove 2 (center) to Plaster Line	64' (19.51 M)
Lighting Cove 2 (center) Height from Stage Floor	65' (19.81 M)
Balcony Rail to Plaster Light at Center	60' (18.29 M)
Last Row of Orchestra Seating to Orchestra Pit	65' (19.81 M)
Height of Balcony Rail from Orchestra Floor	11' (3.35 M)
Pit Depth	8' (2.44 M)
Grid Height	65' (19.81 M)

Fly System

We have a single purchase counterweight system, with a maximum capacity of 1000 lbs. per arbor including pipe weight, which is 100 lbs. This allows a working load limit of 900 lbs. above pipe weight.

- 50 battens total, 21 in constant use for electrics, cyc, and masking.
 - 20 battens available for road use.
- Battens are schedule 40, 1-1/2" black iron pipe.
- Loading can occur from the bridge or mid rail.
- Mid rail is hemp/spot line friendly stage right and left.

Line Set Schedule

Line Set Schedule	Distance from Plaster Line	Pipe Length
House Curtain/Grand Drape	2' (0.61 M)	43' - 0" (13.11 M)
1 - Portal Border	2' - 2" (0.66 M)	54' - 0" (16.46 M)
2 - Portal Legs	2' - 8" (0.81 M)	54' - 0" (16.46 M)
3 - 1st Electric	3' - 8" (1.12 M)	54' - 0" (16.46 M)
4 - Work Lights	4' - 8" (1.42 M)	48' - 0" (14.63 M)
5 - Spare	6' - 2" (1.88 M)	48' - 0" (14.63 M)
6 - Spare	6' - 8" (2.03 M)	48' - 0" (14.63 M)
7 - Spare	7' - 2" (2.18 M)	48' - 0" (14.63 M)
8 - Spare	7' - 8" (2.34 M)	48' - 0" (14.63 M)
9 - Spare	8' - 2" (2.49 M)	48' - 0" (14.63 M)
10 - Spare	8' - 8" (2.64 M)	48' - 0" (14.63 M)
11 - Spare	10' - 2" (3.10 M)	48' - 0" (14.63 M)
12 - 1st Border	11' - 2" (3.40 M)	48' - 0" (14.63 M)
13 - Spare	11' - 8" (3.56 M)	48' - 0" (14.63 M)
14 - 1st Legs	12' - 2" (3.71 M)	50' - 0" (15.24 M)
15 - 2nd Electric	13' - 2" (4.01 M)	48' - 0" (14.63 M)
16 - Spare	15' - 2" (4.62 M)	48' - 0" (14.63 M)
17 - Spare	15' - 8" (4.78 M)	48' - 0" (14.63 M)
18 - Spare	16' - 8" (5.08 M)	48' - 0" (14.63 M)
19 - Spare	17' - 8" (5.38 M)	48' - 0" (14.63 M)

citycollegecenterforthearts

20 - Black Backdrop	18' - 2" (5.54 M)	48' - 0" (14.63 M)
21 - Projection Screen	19' - 8" (5.99 M)	48' - 0" (14.63 M)
22 - Spare	20' - 2" (6.15 M)	48' - 0" (14.63 M)
23 - 2nd Border	20' - 8" (6.30 M)	48' - 0" (14.63 M)
24 - 2nd Legs	21' - 8" (6.60 M)	50' - 0" (15.24 M)
25 - 3rd Electric	22' - 8" (6.91 M)	48' - 0" (14.63 M)
26 - Spare	24' - 8" (7.52 M)	48' - 0" (14.63 M)
27 - Spare	25' - 2" (7.67 M)	48' - 0" (14.63 M)
28 - Spare	26' - 2" (7.98 M)	48' - 0" (14.63 M)
29 - 4th Electric	27' - 2" (8.28 M)	48' - 0" (14.63 M)
30 - Spare	28' - 2" (8.58 M)	48' - 0" (14.63 M)
31 - Black Traveler	29' - 8" (9.04 M)	48' - 0" (14.63 M)
32 - 3rd Border	30' - 8" (9.35 M)	48' - 0" (14.63 M)
33 - 3rd Legs	31' - 2" (9.50 M)	48' - 0" (14.63 M)
34 - Black Scrim	31' - 8" (9.65 M)	50' - 0" (15.24 M)
35 - 5th Electric	32' - 8" (9.96 M)	48' - 0" (14.63 M)
36 - 6th Electric	33' - 8" (10.26 M)	48' - 0" (14.63 M)
37 - Spare	35' - 2" (10.72 M)	48' - 0" (14.63 M)
38 - Spare Legs	36' - 2" (11.02 M)	48' - 0" (14.63 M)
39 - Spare	37' - 2" (11.33 M)	48' - 0" (14.63 M)
40 - Spare Ellipsoidals	37' - 8" (11.48 M)	48' - 0" (14.63 M)
41 - Spare	38' - 2" (11.63 M)	48' - 0" (14.63 M)
42 - Spare Pars	38' - 8" (11.79 M)	48' - 0" (14.63 M)
43 - Spare	40' - 2" (12.24 M)	50' - 0" (15.24 M)
44 - 7th Electric	41' - 2" (12.55 M)	48' - 0" (14.63 M)
45 - Not In Use	42' - 2" (12.85 M)	48' - 0" (14.63 M)
46 - Not In Use	42' - 8" (13.00 M)	46' - 0" (14.02 M)
47 - Not In Use	43' - 2" (13.16 M)	46' - 0" (14.02 M)
48 - Blue Scrim	44' - 2" (13.46 M)	47' - 0" (14.33 M)
49 - Plastic Cyclorama	44' - 8" (13.61 M)	58' - 0" (17.68 M)
50 - Not In Use	44' - 8" (13.61 M)	50' - 0" (15.24 M)

Curtains

Marian Anderson Theater has the following drapes available for use:

- Act Curtain (Grand Drape)
 - Manual Operation (Stage Right)
 - Flies from above with split in the middle
- 1 Pair of black, framed Portal Legs
- 1 pair of black Portal borders
- 3 pairs of black legs (30' x 12' / 9.14 x 3.66 M)
- 3 pair black borders (10' x 50' / 3.05 x 15.24 M)
- 1 black traveler (30' x 50' / 9.14 x 15.24 M)
- 1 black shark tooth scrim (30' x 50' / 9.14 x 15.24 M)
- 1 rear projection screen (30' x 50' / 9.14 x 15.24 M)
- 1 blackout curtain (30' x 50' / 9.14 x 15.24 M)
- 1 wrap around cyclorama
 - Composed of two pieces a plastic sheet and blue scrim
 - These pieces must be used together.

Power and Lighting

Consult with the Production Manager as to what will be required to integrate your show into the facility as smoothly and efficiently as possible.

Marian Anderson Theater has 72 SCR 7kw Dimmers. The lighting console in use is an ETC Element 60.

Rep Lighting: Conventional stage lighting inventory is all incandescent consisting of:

- Century Strand 15°
- Berkey Colortran 12°
- Altman 360Qs with iris
- Par 64
- Colortran 8" Fresnel
- Berkley Colortran 3 cell Cyclorama lights
- 1 Altman Satellite Follow Spot

All Circuiting is done via the hard patch panel located on stage right.

All stage lighting equipment and accessories are 20 amp twist lock.

Auxiliary power is available on stage right. Auxiliary power includes one 3-phase 400 amp and one 3-phase 800 amp service. Use of these amps must be requested in advanced to ensure proper personnel are on site for load in of your show.

Audio

Marian Anderson Theater provides the following audio equipment:

Mixers

- 1- Behringer X32 Digital Mixer
- 1- Behringer S32 Digital Stage Box

Speakers and Subwoofers

- 2- Turbosound iQ15 Powered Speaker
- 2- Turbosound iQ18b Powered Subwoofer
- 2- Turbosound iQ12 Powered Speaker (side fill)

Monitors

- 6- Yamaha CM 12V monitors
- 3- Crown XTi1001 monitors

Microphones

- 14- Shure SM58 Dynamic Wired Microphones
- 2- Shure SM58 Beta Wired Vocal Microphones
- 8- Shure SM57 Wired Instrument Microphones
- 14- Sennheiser e835 (RF) Wireless Microphones
- 2- Sennheiser ew100 G3 (Lav) Wireless Microphones
- 12- Sennheiser ew G4 (Lav) Wireless Microphones
- 6- Shure MX412D Table Microphones
- 2- DPA 4099 Instrument Microphones
- 2- Rode NT1 Studio Condenser Microphones
- 2 Neumann KMR82i Shotgun Microphones
- 5- Crown PCC160 Boundary Layer Microphones
- 1- CAD KM212 Dynamic Kick Drum Microphone
- 1- CAD SN210 Snare Drum Microphone
- 3- CAD TM211 Tom Drum Microphones
- 2- CAD CM217 Condenser Microphones

Miscellaneous

- 1- ProD2 DI Box
- 1- ProD1 DI Box
- 25- Microphone Stands
- Assorted XLR Cables

Video

Projection Screen: 16:19 ratio rear projection screen, image area 50' x 30' (15.24 x 9.14 M)

Available Projector: Epson EB-PU2010B 3LCD Laser Projector with 4K Enhancement

- 10,000 Lumens color/white brightness
- Powered Lens

citycollegecenterforthearts

- 1920 x 1200 x 2 Enhanced 4K Resolution
- VGA and HDMI ports

Video System Routing: Direct connection to projector

Stage Manager Panel

The Stage Manager Panel is located on Stage Right.

Orchestra Pit

Marian Anderson Theater offers an orchestra pit that must be requested in advance to ensure platforms are cleared prior to load in of your show.

- 8' Deep (2.44 M)
- When the orchestra pit is filled it consists of 20 individual modules that are manually installed
 - There is no lift system for the orchestra pit.
- The orchestra pit can accommodate 50 musicians.

Orchestra Equipment

Marian Anderson Theater has the following items available for orchestral use:

- Steinway 9' (2.74M) model D concert grand piano
- 60 Music Stands
- 60 Music Chairs
- Choral Risers which accommodate 60 people
- Musician's Risers a total of 6 4'x8' platforms (1.22 x 2.44M)
 - Riser Heights:
 - 8" (0.20 M)
 - 16" (0.41 M)
 - 24" (0.61 M)
- 10 sections of Wenger Acoustical Shells

Loading Dock

The loading dock for Marian Anderson Theater is located on the south side of Aaron Davis Hall. The entrance is on 133rd Street and Convent Avenue. The loading dock is attached to the scene shop which has doors directly to the center stage back wall.

Dressing Rooms

citycollegecenterforthe**arts**

There are no dressing rooms or lavatory facilities on stage level. Not all dressing rooms listed here are available for every event; rooms will be assigned at the discretion of the Performing Arts Technical Manager.

- 4 rooms for 1-2 people (shared restroom)
- 2 rooms for up to 25 people each (shared restroom)
- 1 room for up to 20 people (shared restroom)